

ORGANIC SEMICONDUCTOR SOLID ELECTROLYTIC CAPACITORS

NEW



Lead type, Long Life(5000 hours at 105°C)
Series

- Long Life of 5000 hours at 105°C
- High reliability
- Designed for use industrial equipment

APRO-CAP

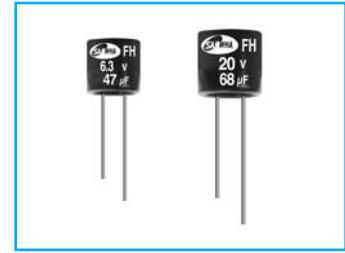

Item	Characteristics	
Operating temperature range	-55 ~ +105°C	
Leakage current max.	Not more than the values in Table 1	
Capacitance tolerance	±20% at 120Hz, 20°C	
Dissipation factor max.	Not more than the values in Table 1	
ESR	Not more than the values in Table 1	
Low temperature characteristics (Impedance ratio at 100kHz)	Z-55°C / Z+20°C	Z+105°C / Z+20°C
	0.75~1.25	0.75~1.25
Load life * (after application of the rated voltage for 5000 hours at 105°C)	Leakage current	Less than specified value
	Capacitance change	Within ±30% of initial value
	tan δ	Less than 150% of specified value
Moisture resistance (after leaving capacitors under no load at 60°C for 1000 hours 90~95% R.H.)	Leakage current	Less than specified value
	Capacitance change	Within ±10% of initial value
	tan δ	Less than 150% of specified value

* Note: 1. To use an APRO-CAP when the operating temperature exceeds 85°C on a component with a rated voltage of 25V, reduce the voltage by 0.25V for every degree (1°C) relative to the value 85°C (25V).

2. If any doubt arises, measure the current after applying voltage (voltage treatment) for 30 minutes at 105°C. The rated voltage should be applied for 6.3 to 20WV, while a temperature reduction voltage should be applied for 25WV.

● DRAWING (Unit : mm)

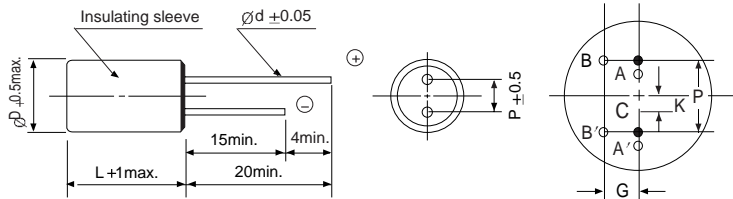

C: The central point of A-A'

● PART NUMBER SYSTEM (See Page 50)

ØD × L	Code	P	Ød	K max.	G max.
6.3 × 6.8	6L06H	2.5 ± 0.5	0.5	0.5	0.5
6.3 × 9.8	6L09H	2.5 ± 0.5	0.5	0.5	0.5
8 × 10.5	0810M	3.5 ± 0.5	0.6	0.8	0.8
10 × 10.5	1010M	5.0 ± 0.5	0.6	0.8	0.8

● DIMENSIONS

µF \ WV	6.3	10	16	20	25
4.7					6.3 × 6.8
6.8					6.3 × 6.8
10					6.3 × 6.8
15				6.3 × 6.8	6.3 × 9.8
22				6.3 × 6.8	
33			6.3 × 6.8	6.3 × 9.8	
47	6.3 × 6.8		6.3 × 9.8	8 × 10.5	
68	6.3 × 9.8	6.3 × 9.8	8 × 10.5	8 × 10.5	
100	8 × 10.5	8 × 10.5	8 × 10.5	10 × 10.5	
150	8 × 10.5	10 × 10.5	10 × 10.5		
220	10 × 10.5	10 × 10.5			
330	10 × 10.5				

FH Series

● Table1. FH Series Characteristics List

WV	uF	øD(mm)	L(mm)	ESR(mΩ)max. at 20°C 100~300kHz	Ripple current (mA rms)at 45°C 100kHz	Dissipation factor at 20°C 120Hz	Leakage Current (uA)(max.) after 2minutes
6.3	47	6.3	6.8	60	1430	0.07	5.92
6.3	68	6.3	9.8	50	2000	0.07	8.57
6.3	100	8	10.5	30	2670	0.07	12.60
6.3	150	8	10.5	30	2780	0.07	18.90
6.3	220	10	10.5	27	3370	0.07	27.72
6.3	330	10	10.5	25	3500	0.07	41.58
10	68	6.3	9.8	50	2000	0.07	13.60
10	100	8	10.5	30	2670	0.07	20.00
10	150	10	10.5	28	3260	0.07	30.00
10	220	10	10.5	27	3370	0.07	44.00
16	33	6.3	6.8	70	1370	0.07	10.56
16	47	6.3	9.8	60	1830	0.07	15.04
16	68	8	10.5	36	2600	0.07	21.76
16	100	8	10.5	30	2740	0.07	32.00
16	150	10	10.5	28	3260	0.07	48.00
20	15	6.3	6.8	90	1200	0.07	6.00
20	22	6.3	6.8	70	1300	0.07	8.80
20	33	6.3	9.8	70	1710	0.07	13.20
20	47	8	10.5	40	2450	0.07	18.80
20	68	8	10.5	36	2600	0.07	27.20
20	100	10	10.5	30	3210	0.07	40.00
25	4.7	6.3	6.8	100	1130	0.07	2.35
25	6.8	6.3	6.8	100	1140	0.07	3.40
25	10	6.3	6.8	90	1150	0.07	5.00
25	15	6.3	9.8	70	1650	0.07	7.50