

MW series 5mmL, For General Audio Equipment

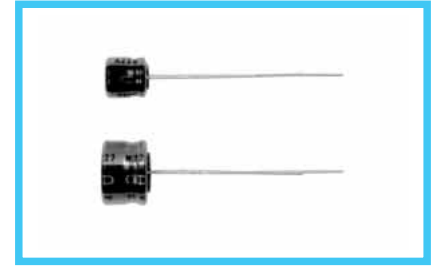

● Eco-Products acoustic series, with 5mm height.

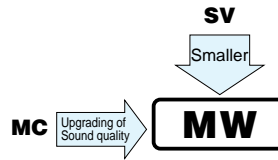

Specifications

Item	Performance Characteristics									
Category Temperature Range	-40 ~ +85°C									
Rated Voltage Range	4 ~ 50V									
Rated Capacitance Range	0.1 ~ 470μF									
Capacitance Tolerance	±20% at 120Hz, 20°C									
Leakage Current	After 2 minutes' application of rated voltage, leakage current is not more than 0.01CV or 3 (μA), whichever is greater.									
tan δ	Measurement frequency : 120Hz, Temperature : 20°C									
	Rated voltage (V)	4	6.3	10	16	25	35	50		
Stability at Low Temperature	Measurement frequency : 120Hz									
	Impedance ratio ZT / Z20 (MAX.)	Rated voltage (V)		4	6.3	10	16	25	35	50
		Z-25°C / Z+20°C	7	4	3	2	2	2	2	
Z-40°C / Z+20°C	15	8	6	4	4	3	3			
Endurance	After 1000 hours' application of rated voltage at 85°C, capacitors meet the characteristics requirement listed at right.				Capacitance change				Within ±20% of initial value	
					tan δ				200% or less of initial specified value	
					Leakage current				Initial specified value or less	
Shelf Life	After leaving capacitors under no load at 85°C for 1000 hours, they meet the specified value for endurance characteristics listed above.									
Marking	Printed with black color letter on gold sleeve.									

Radial Lead Type

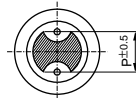
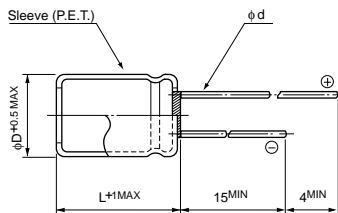

	(mm)			
φD	4	5	6.3	8
P	1.5	2.0	2.5	2.5
φd	0.45	0.45	0.45	0.45

Type numbering system (Example : 25V 10μF)

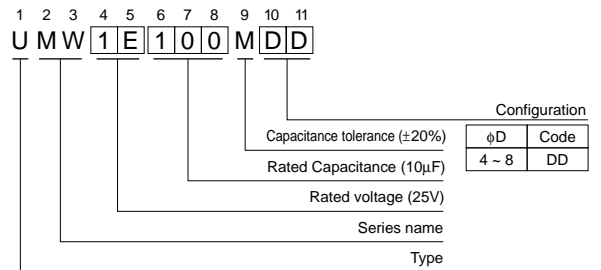

Dimensions

Cap. (μF)	code	φD × L (mm)												
		4		6.3		10		16		25		35		50
		0G	0J	1A	1C	1E	1V	1H						
0.1	0R1												4 × 5	1.0
0.22	R22												4 × 5	2.0
0.33	R33												4 × 5	2.8
0.47	R47												4 × 5	4.0
1	010												4 × 5	8.4
2.2	2R2												4 × 5	13
3.3	3R3												4 × 5	17
4.7	4R7												4 × 5	20
10	100												4 × 5	33
22	220		4 × 5	28	5 × 5	33	5 × 5	37	6.3 × 5	42	6.3 × 5	46	8 × 5	52
33	330	4 × 5	28	5 × 5	37	5 × 5	41	6.3 × 5	49	6.3 × 5	52	8 × 5	62	8 × 5
47	470	4 × 5	33	5 × 5	45	6.3 × 5	52	6.3 × 5	58	8 × 5	70	8 × 5	80	
100	101	5 × 5	56	6.3 × 5	70	8 × 5	80	8 × 5	92	8 × 5	110			
220	221	6.3 × 5	96	8 × 5	110	8 × 5	135							
330	331	8 × 5	145	8 × 5	170									
470	471	8 × 5	185											

Frequency coefficient of rated ripple current

Frequency	50 Hz	120 Hz	300 Hz	1 kHz	10 kHz ~
Coefficient	0.70	1.00	1.17	1.36	1.50

Please refer to page 19, 20, 21 about the formed or taped product spec.
Please refer to page 3 for the minimum order quantity.

Rated Ripple (mA rms) at 85°C 120Hz